



Features:

- Suitable for the filling in blank areas in patch panels using a LGX footprint.
- Small footprint, light weight aluminum structure and easy installation
- LGX foot print
- Push pull alignment pins.

- **Technical:**
- Dimensions: 5.13mm x1.2mm
- Pin Dimensions: 4.675mm
- Environmental temperature: -25°C ~ +55°C
- Relative humidity: ≤85% (30°C)

About

The LGX blank adapter plate is a simple light weight assembly used to fill in blank holes in LGX type patch panels.

How To Order:

For more information on how to order or request a quote on our fiber optic cable and communications products.

Request a quote:

World Wide Sales Center

Fibertronics Inc.

E-mail: Sales@Fibertronics.com

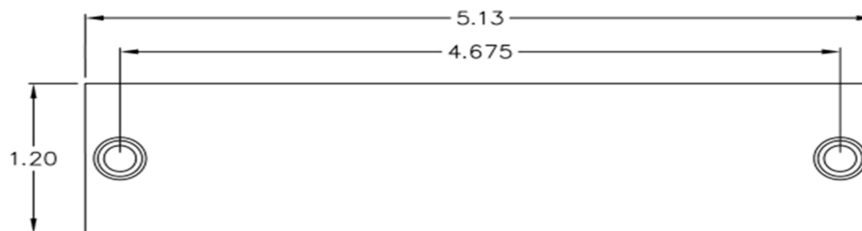

LGX Specs.



